

PC180 – THRU BEAM PHOTOCELLS

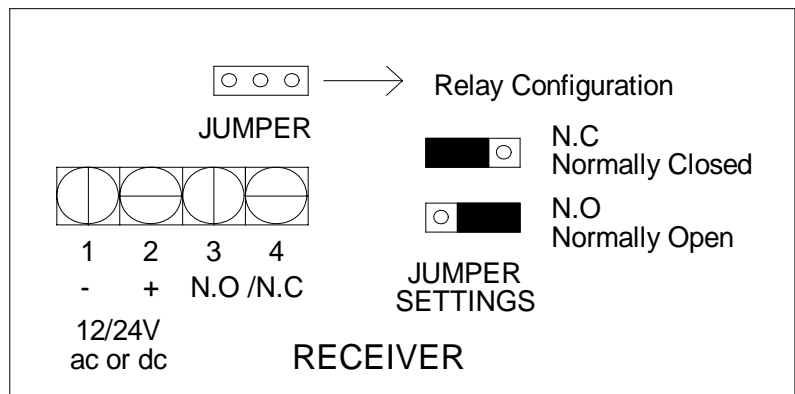
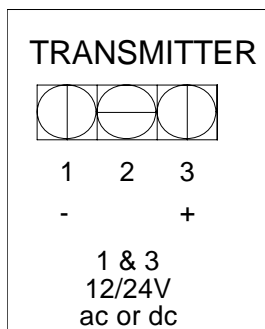
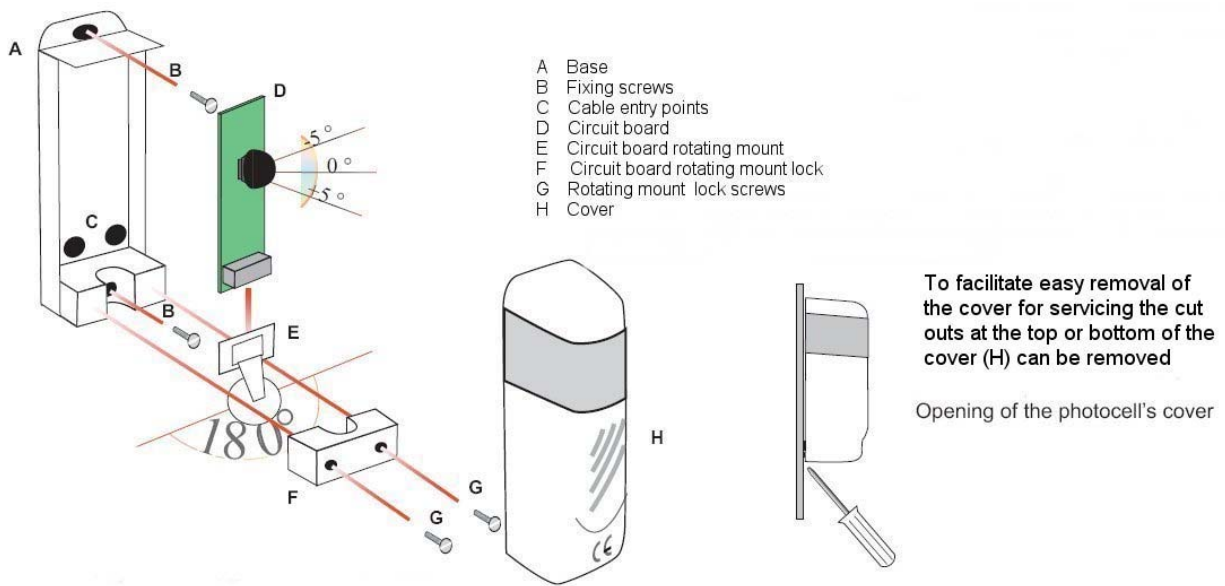

The PC180 comprises a pair of photocells, a transmitter and a receiver, these are installed either side of the door or gate opening, this creates an infra red beam, if the beam is broken the door or gate will not operate or if it is moving it will stop or stop and reverse, dependent upon the control unit.

The photocell's are normally positioned either side of the opening at a height of about 300mm

Before installation ensure that power to the control unit is switched off.

1. Remove the covers of both photocells and identify the receiver, it has 4 connection terminals.
2. Run a 4 core cable from the control unit to the receiver and a two core cable from the control unit to the transmitter and make connections – see connection details above
3. Fix the receiver to one side of the opening and the transmitter to the other, switch on power to the control unit.. Now adjust the photocell circuit boards so the transmitter aligns with the receiver when the two are correctly aligned the red LED light will be on, now tighten the rotating mount locking screws.
4. Set the relay configuration jumper as required, default is normally closed
5. Operate the door or gate and break the beam by passing an obstacle through it, the LED light on the receiver will switch off and the door or gate will stop, or stop and reverse depending upon the control unit
6. Fix covers to the transmitter and receiver, to enable the covers to be easily removed for servicing the cut out on the bottom of the front cover can be removed using a pair of cutters

SYNCRO MODE

When 2 sets of photocells are used and there is a possibility of interference between them, use the syncro feature by connecting the photocells as shown ensuring J1 is fitted to both transmitter and receiver and the supply voltage is AC

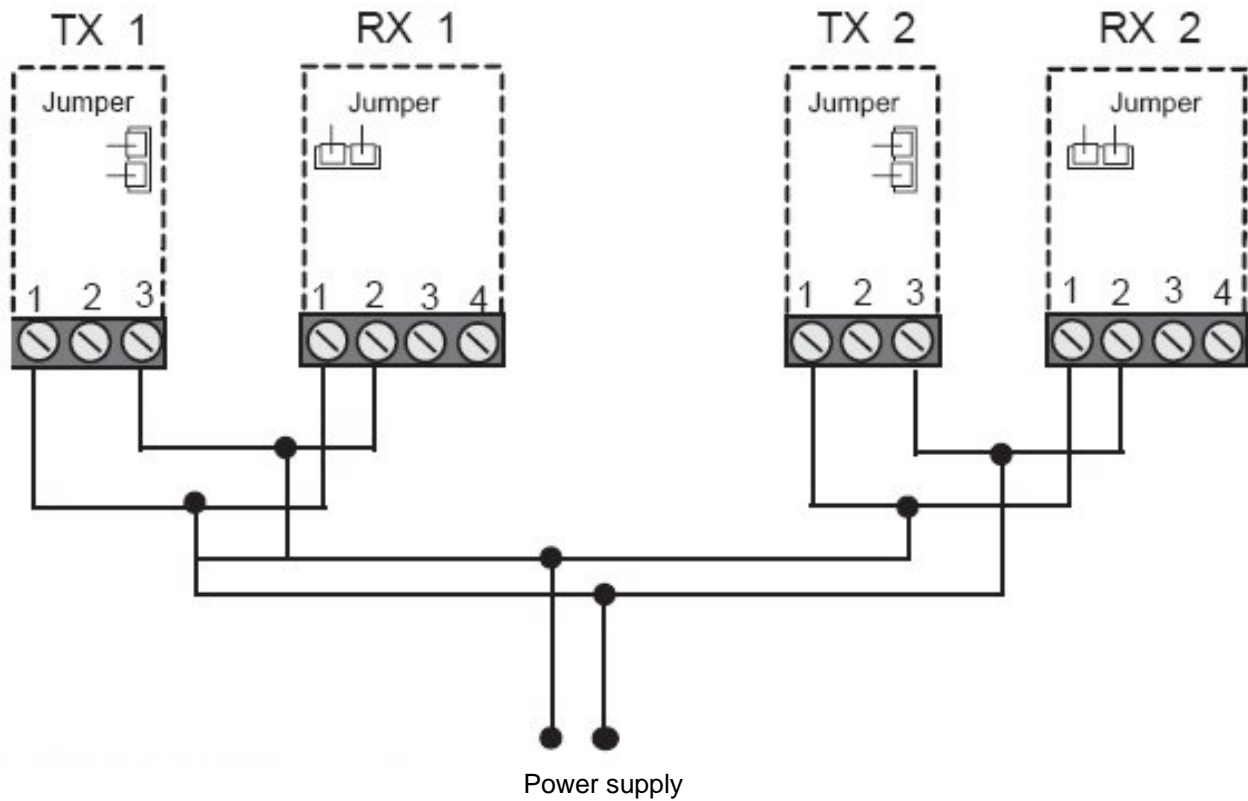

SPECIFICATIONS	
Power supply	12 or 24Vac or dc
Power supply limits	18-35V dc 15-28V ac
Output	Normally open (NO) and Normally closed (NC) relay contacts
Relay Rating	0.5A 48V ac dc
Range	Up to 20 metres
Temperature	-20 to +60 deg C
Dimensions	103 x 33 x 36 mm
Protection	IP55